

**Kulturhaus „Sonne“, Saal Erdgeschoss Kinderflohmkt
44 Stande (Tisch + Sitzplatz)**

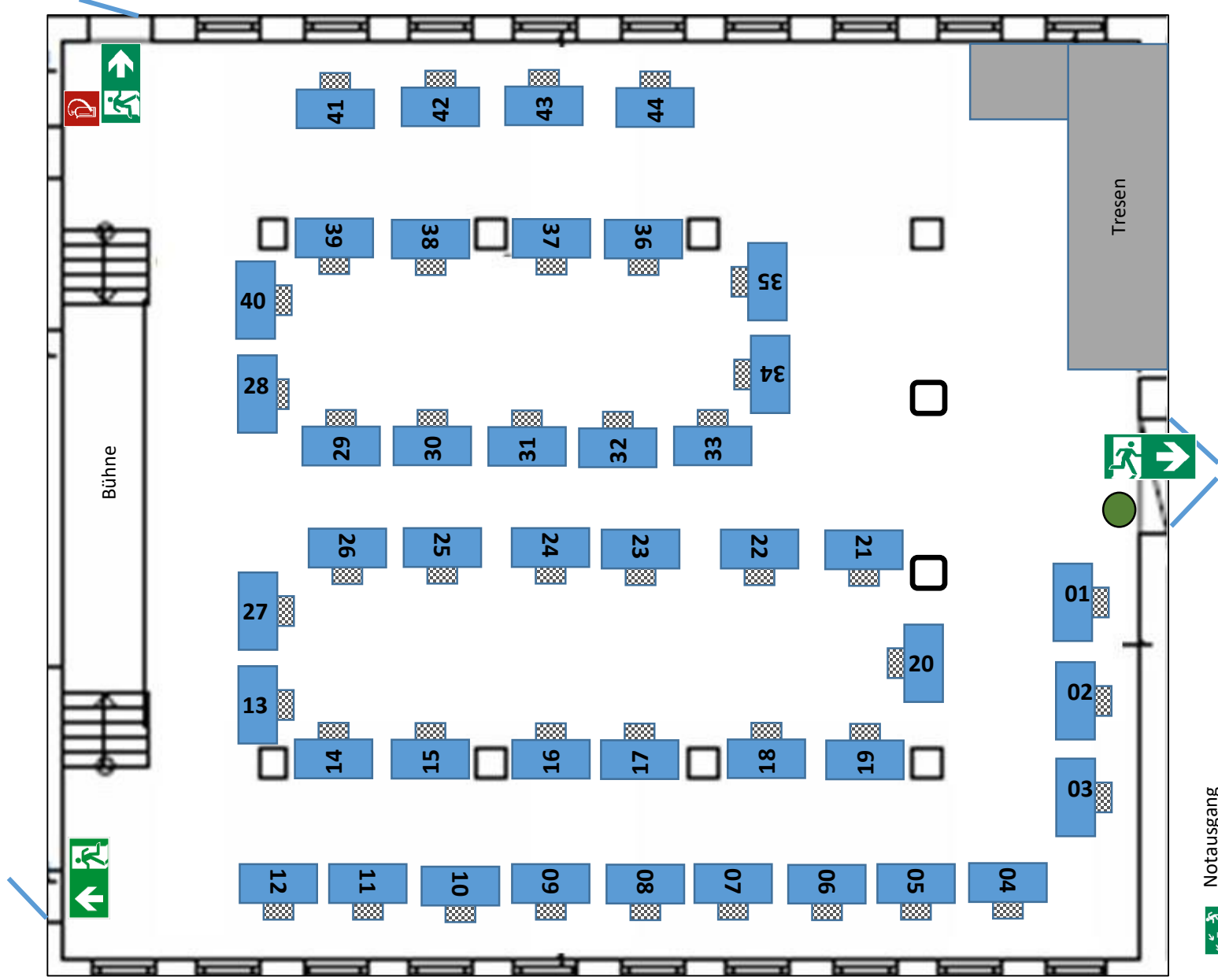

Notausgang
mit
Fluchtrichtung



Feuerloscher



Eigener Standort



Tisch 1,3 m x ,065 m



Stuhl 0,5 m x 0,5 m



Saal

303 m²

18.81m x 16.12 m

Bestuhlungsplan
erstellt im
Kulturhaus „Sonne“
Mastab 1:100

Tresen

Buhne

44 numbered tables (01-44) and their corresponding chairs are arranged in the room. The tables are blue rectangles, and the chairs are small squares with a checkered pattern. The tables are arranged in a grid-like pattern, with some tables having chairs on both sides and others having chairs on one side. The tables are numbered as follows: 01-03, 04-06, 07-09, 10-12, 13-15, 16-18, 19-21, 22-24, 25-27, 28-30, 31-33, 34-36, 37-39, 40-42, 43-44.